

SWINDON TOWN

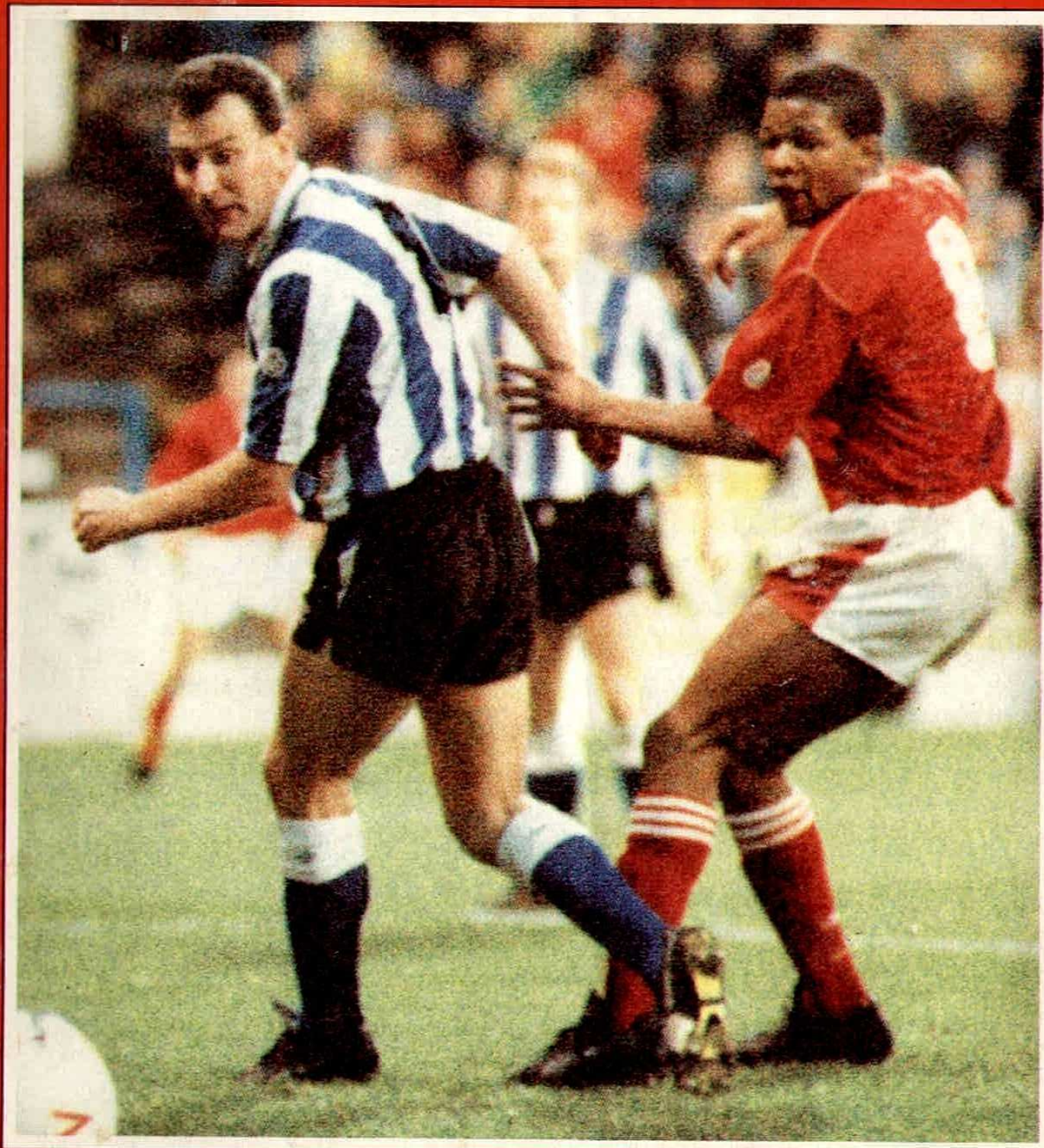

OFFICIAL CLUB SPONSOR



97.2

RUMBELOWS CUP
THIRD ROUND REPLAY

**SHEFFIELD
WEDNESDAY**

TUESDAY NOVEMBER 6th 1990
KICK-OFF 7.45 p.m.

**TODAY'S
MATCH SPONSOR:**
Sir Seton Wills
and Family

Official Programme £1.00



GWR

FM

97.2

**FIRST FOR SPORT
IN WILTSHIRE**

We offer the most comprehensive sports coverage in the county.

Tune to 97.2 or 102.2 MHz for updates at:

06.45 07.45 08.45 13.10 17.15

Plus our weekend coverage starting on Friday at 17.15 with the exclusive Swindon Town coverage featuring Ossie Ardiles, players and management from the County Ground.

Saturday sport is a full four hours starting at 14.00 with detailed match coverage and radio's first classified football results at 16.55.

Injury list shrinking . . .

A warm welcome to Sheffield Wednesday and all their supporters.

Sheffield are on a high at the moment and in my view were unfortunate to be relegated. Like ourselves, Wednesday are a good footballing team which have one of the countries finest stadiums.

The match at Hillsborough was played at a frantic pace with plenty of good football. Sheffield dominated for long periods and we became stronger towards the end.

I was very pleased with our performance, especially after the debacle at Barnsley. We fought very hard for a draw and in the end were well satisfied. Equally pleasing was that we kept a clean sheet.

Tonight's game will be a very different one especially with the incentive of a home game with Derby County in Round Four. We shall, as usual, go out with a very positive attitude and try to win tonight.

Nicky Tanner has now returned to Liverpool after his months loan with us. We are grateful to Liverpool for

letting us have Nick to help us over some of our injury problems.

Talking of injuries, our list of injured players is now shrinking. I have never known so many senior players injured at one time. Hopefully I haven't spoken too soon and shortly I shall be able to select from a full squad with the exception of Dave Bennett and Colin Calderwood.

We really need your support tonight so let's hear you get behind the lads.

Thank you all for coming and enjoy yourselves tonight.



**WELCOME TO THE
COUNTY GROUND
-HOME OF**



**SWINDON TOWN
FOOTBALL CLUB**

County Ground, Swindon, Wiltshire
SN1 2ED

Telephone:

(0793) 430430 (Main Office and

Commercial Department)

(0793) 611499 (Travel Club)

(0793) 535130 (Rendezvous Club)

Fax: (0793) 536170

President: C. J. Green

Chairman: G. W. Herbert

Vice Chairman: C. M. Howard

Directors: L. Smart, N. H. Arkell,

K. J. Chapman

Chief Executive: P. Day

Manager: O. C. Ardiles

Non Executive Directors:

D. Alderton, R. M. Mattick JP,

M. Z. Tryczynski

Commercial Manager: D. Buswell

Assistant Manager: P. D. Bates

Coach: A. A. Rowland

Youth Team Manager: J. Trollope

Physiotherapist: K. Morris

Hon. Medical Officer:

Dr. J. D. Nicholas

Chaplain: Rev. N. Sands

Official Club Sponsor: GWR FM

Today's Match Sponsors are:

SIR SETON WILLS & FAMILY

The Directors of Swindon Town Football Club would like to express their gratitude to **Sir Seton Wills & Family** for their generosity in sponsoring today's match.

This is the official programme of Swindon Town Football Club. Individuals contributions do not necessarily represent the views of the club.

Edited by club staff with the valued assistance of **Paul Plowman**.

Printed by **Thamesdown Litho**

Front cover: Keep your eye on the ball! Jon Gittens watches as the ball flashes wide of the Wednesday goal.

Welcome to the players, officials
and supporters of

SHEFFIELD WEDNESDAY



SHEFFIELD WEDNESDAY - TEAM PHOTOGRAPH SEASON 1990/91

Back row left to right: Peter Shirtliff, Chris Turner, Carlton Palmer, Kevin Pressman, Lawrie Madden.
Middle row left to right: Roger Spry (Coach), Richie Barker (Assistant Manager), John Sheridan, Dave Bennett (now at Swindon Town), Phil King, Steve McCall, Nigel Worthington, David Hirst, Alan Smith (Physiotherapist).
Front row left to right: Roland Nilsson, Darren Wood, Paul Williams, Ron Atkinson (Manager), Nigel Pearson, Danny Wilson, Trevor Francis.

SHEFFIELD WEDNESDAY - Form Guide

Last ten games

	H	A	Goalscorers	Att.
Sep. 26 Brentford	W2-1		Hirst, Pearson	11,027
29 West Ham Utd.		D1-1	Hirst	28,786
Oct. 3 Brighton & H.A.		W4-0	Wilson, Sheridan, Williams, Pearson	10,379
6 Bristol Rovers		W1-0	Francis	6,413
9 Brentford	RLC2	W2-1	Francis, Pearson	8,227
13 Plymouth Argyle	W3-0		Wilson, Sheridan 2	23,489
20 Port Vale	D1-1		Williams	24,527
23 Barnsley		D1-1	Palmer	23,079
27 Millwall		L2-4	Hirst 2	12,835
31 Swindon	RLC3	D0-0		13,900

Summary of Goalscorers: Hirst 11, Williams 5, Pearson 4, Sheridan 4, Wilson 3, Francis 2, Worthington 1, McCall 1, Shirtliff 1, Palmer 1.

SHEFFIELD WEDNESDAY: The Last 15 Years

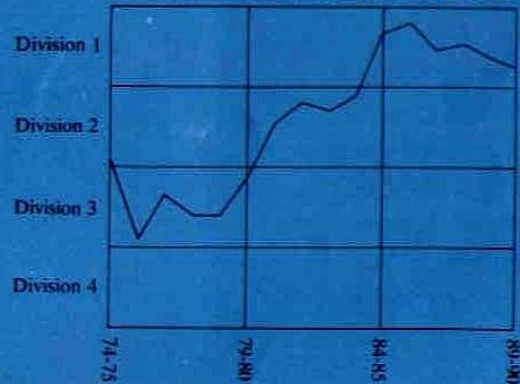

FM 97.2

AND SWINDON TOWN

The squad

Ron Atkinson (Manager). Born Liverpool. Began his professional career at Aston Villa but his name became synonymous with Oxford United, where he figured prominently in their climb into the Football League in 1962 and their rapid rise from the Fourth to the Second Division. In 1971 he became player-manager at Kettering Town, and began his League management career at Cambridge United in 1974, leading them from Division Four to the brink of Division Two. He joined West Brom in 1978, building a successful First Division side before moving to Manchester United in 1981. In his five full seasons at Old Trafford, United never finished out of the top four, won the F.A. Cup twice and reached the League Cup Final. He returned to West Brom in 1987 and then had a brief spell at Atletico Madrid. He joined Wednesday in February 1989.

Trevor Francis (Striker). Born Plymouth. Started with Birmingham City in 1970. Quickly gained recognition as one of the outstanding players of his generation, gaining 52 England caps and becoming a £1 million player when he moved to Nottingham Forest in 1979 after scoring 118 goals in 280 League games. Manchester City also paid £1 million plus for him in 1981. He then went to Sampdoria and later played in the United States with Atlanta before returning to Britain with Glasgow Rangers. Returned to English soccer with Q.P.R., where he became player-manager for a short spell. Wednesday obtained his services on a free transfer in January 1990.

David Hirst (Striker). Born Barnsley. Started at Barnsley where he made 29 appearances scoring 9 goals before joining Wednesday for £200,000 in August 1986. Was a member of the England Youth Team to tour China in 1986 and South America in 1987. Has 7 England Under-21 caps.

Phil King (Defender). Born Bristol. Joined the Owls for £400,000 from the Town in November 1989 and missed only two games last season, making a big impact and proving popular with supporters. Came to Swindon from Torquay United for £12,500 early in 1987 and was previously with Exeter City.

Lawrie Madden (Defender). Born London. Veteran of over 400 League and Cup games with Mansfield, Charlton, Millwall and Wednesday. Went to Hillsborough in 1983 on a free transfer and helped the Owls win promotion. In his early career he played as a part-timer to concentrate on his studies, and he now boasts degrees from Manchester and Sheffield Universities.

Steve McCall (Defender). Born Carlisle. After over 259 League games for Ipswich Town and England honours at Youth, Under-21 and 'B' levels, he joined Wednesday in June 1987 for £250,000 but suffered a broken leg in only his fifth appearance. It marked the beginning of a long struggle for fitness which was not helped when he later suffered a cartilage injury. He made three appearances towards the end of last season.

Roland Nilsson (Defender). Born Helsingborg. Swedish International capped 35 times and a member of his country's 1990 World Cup side. Joined Wednesday in December 1989 from Gothenburg for £375,000. Recently absent through injury, having been carried off at Millwall.

Carlton Palmer (Midfield). Born Oldbury. Began with West Brom, for whom he made some 140 appearances before joining Wednesday for a club record fee of £750,000 in February 1989. Has gained 4 England Under-21 caps and played for England 'B' last season.

Nigel Pearson (Defender). Born Nottingham. Plucked from non-League Heanor Town in 1981, he made over 180 appearances for Shrewsbury Town before joining Wednesday for £250,000 in October 1987. Has been club captain for two years.

Kevin Pressman (Goalkeeper). Born Fareham. Celebrates his 23rd birthday today. Joined Wednesday as an apprentice in June 1984 after being on schoolboy forms. Became a full professional in November 1985. A former England schoolboy and England Youth player, he also has one England Under-21 cap. Made his League debut in March 1987 when Martin Hodge's long, consecutive run came to an end.

Peter Shirliff (Defender). Born Chapelton, Sheffield. Signed schoolboy forms in 1975 and went on to become an apprentice in June 1977. Moved up to professional level in October 1978. He made 223 appearances for Wednesday before joining Charlton in July 1986 and over 100 League appearances for the London side before returning to Hillsborough for a £500,000 fee in the summer of 1989.

John Sheridan (Midfield). Born Manchester. Made over 250 appearances for Leeds and scored some 50 goals, winning Republic of Ireland caps at Youth, Under-21 and Full International levels. Joined Wednesday in November 1989 for £500,000 after a brief spell at Nottingham Forest, where he made only one appearance in over three months.

Chris Turner (Goalkeeper). Originally with Wednesday as a schoolboy from September 1973, he made 115 appearances before being transferred to Sunderland for £80,000 in 1979. He made 223 appearances for the Roker club before moving to Manchester United for £275,000 in 1985. After some 80 games for the Old Trafford club, he rejoined Wednesday in September 1988 for £175,000.

Steve Whitton (Striker). Born East Ham. Has some 240 League appearances to his credit with Coventry, West Ham, Birmingham and Wednesday. Cost the Owls £275,000 in March 1989, and played a significant part in the push to avoid relegation that year. Last season he scored four times in the record 8-0 League Cup triumph at Aldershot, but his senior outings were infrequent. Had a loan spell at Halmstad, in Sweden, in the summer.

Paul Williams (Striker). Charlton's leading scorer in the last two seasons, having reached them from non-League Woodford Town and made such an impact following his debut in September 1987 that he gained England Under-21 recognition. Studied accountancy before becoming a full time professional. Joined Wednesday in August 1990 for a £600,000 fee.

Danny Wilson (Midfield). Born Wigan. Started with Wigan Athletic but began his League career at Bury in late 1977, since when he has made over 550 League and Cup appearances, scored some 90 goals, and collected nearly 20 caps for Northern Ireland. Joined Chesterfield in 1980 and had a year at Nottingham Forest before enjoying his best spells with Brighton and, since 1987, Luton Town. He helped Luton to two League Cup finals – and contributed to their dramatic escape from relegation last season. Cost Wednesday £200,000 in the summer of 1990.

Darren Wood (Defender). Made over 100 appearances for Middlesbrough and some 150 for Chelsea before joining Wednesday in January 1989 for £400,000. Has not appeared this season due to injury.

Nigel Worthington (Defender). Born Ballymena. Began his League career with Notts County for whom he made over 80 appearances before joining Wednesday for £125,000 in February 1984. Capped 28 times for Northern Ireland.

GWR FM 97.2

THE WINNING COMBINATION

PAUL PLOWMAN continues his season by season look back at Swindon Town through the years.

1967/68

Two new signings appeared in the Swindon line-up on the opening day against Brighton, right-half Dave Harper from Ipswich Town and right-winger Barry Lowes from Coventry City. But collectively they made only six appearances for the Town, with injury restricting Lowes to just two hours and four minutes League football.

Danny Williams wasted no time in securing a replacement for Lowes. His choice was Norwich City's Don Heath, who made his debut in a 4-0 win over Northampton on September 16.

Another new face in a Swindon shirt, later in 1967/68, was that of Peter Noble. Signed from Newcastle United on January 25, his first full appearance was in a 5-0 crushing of Grimsby a month later. The Town's fifth goal in that victory, incidentally, was an own goal conceded by the visiting left-back, a certain Graham Taylor! Noble's inclusion at number eight followed a two-goal strike after coming on as a substitute against Bury three days earlier.



Pat Terry, a hat-trick in 10 minutes.

Don Rogers and John Trollope made maximum League appearances for the fourth successive season. And, as in 1966/67, the 'ever-present' record also went to wing-half Stan Harland. The Liverpoolian was handed the number nine shirt in the Town's final two games, after hitting a hat-trick for the reserves at Northampton on April 30.

Rogers was the top goalscorer, as he had been the previous season, and was again the highest scoring winger in the Football League. His tally in 1967/68 was 28 goals, 25 coming in Division Three. He was followed by the all-action Pat Terry, who grabbed 19. In a 4-0 win over Bournemouth at the County Ground on October 14, Terry plundered a hat-trick in the opening ten minutes.

The Town's League form was once again patchy. Four wins out of six up to the turn of the year took them to third place, but following a 4-0 victory over The Orient on March 12, Swindon went nine games without a win, although only two ended in defeat. They eventually finished tenth.



New Signing Don Heath



Swindon's efforts in the League Cup that season are best forgotten. They were unable to defeat Fourth Division Newport County at home in the First Round – conceding an own goal through Mel Nurse and needing a penalty to force a 1-1 draw – and went down 2-0 in the replay.

In the F.A. Cup, Salisbury, Luton Town and Blackburn Rovers were all beaten at the County Ground before the Fourth Round draw gave the Town a trip to Hillsborough. Roger Smart gave Swindon a 34th minute lead, but Wednesday equalised through Wilf Smith in the 65th and grabbed a winner with just five minutes to go. The scorer was big John Ritchie, who had dealt the Town a similar knockout blow in the same competition seven years earlier when at Kettering.

ARKELL'S

EST. **BREWERY** 1843

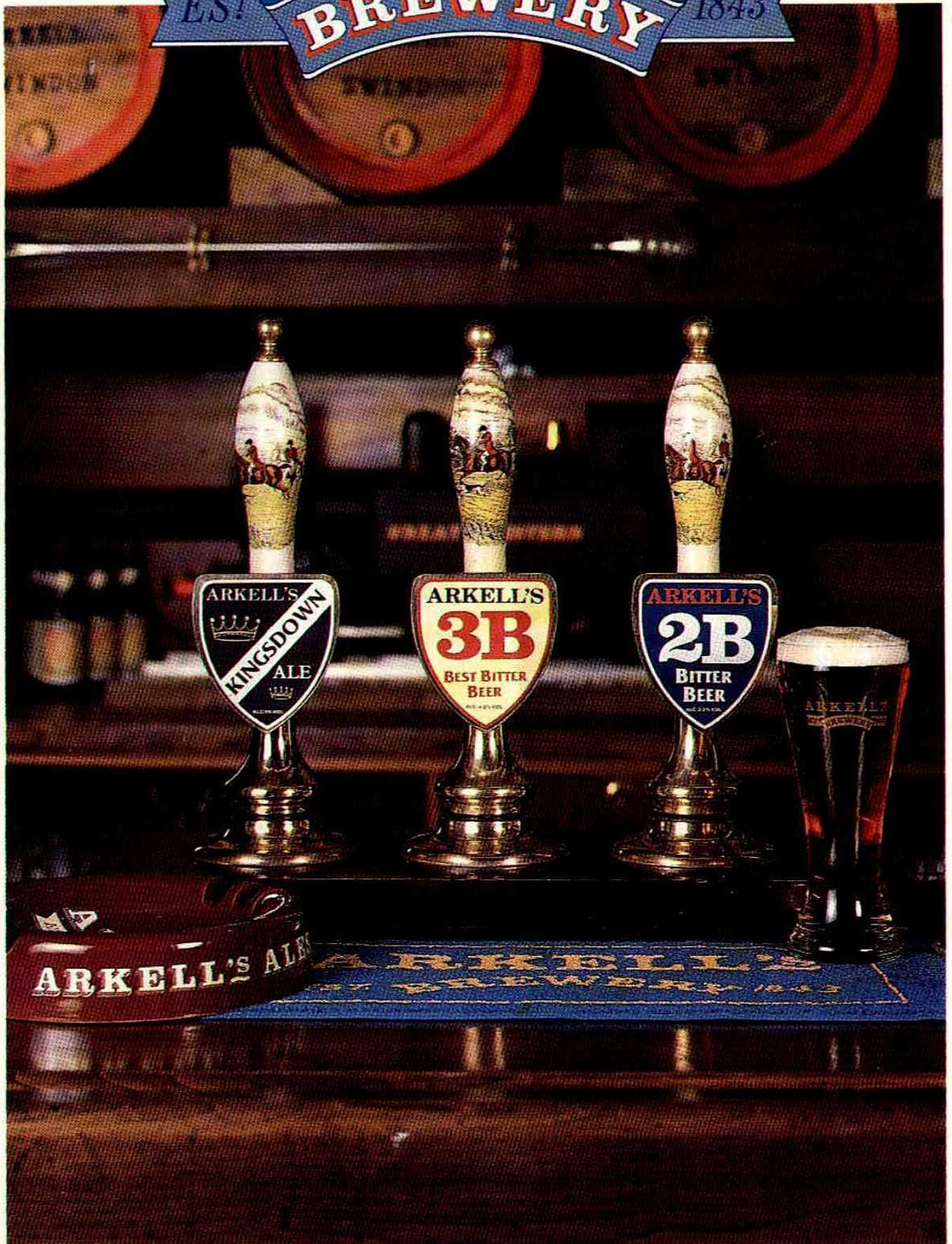

Highlights . . .

With two teams tonight doing battle in a replay for a place in Round Five of the Rumbelows Cup, let's consider some of the highlights from last weeks other ties.

Third Division Orient held Crystal Palace to a goal-less draw at Selhurst Park. Steve Coppell's side had put eight past Southend United in the competition.

Matthew Le Tissier and Rod Wallace were on target in Southampton's 2-0 victory at Ipswich.

In the big match at Maine Road, Manchester City lost their unbeaten home record this season, 2-1 to Arsenal. Perry Groves and Tony Adams got the "Gunners" goals before Clive Allen hit a late consolation.

Second Division Middlesbrough scored twice in fifteen minutes in the first half to knock out Norwich 2-0 at Ayresome Park, thanks to Paul Kerr and John Hendrie.

Trevor Putney made his comeback for the "Canaries" from a broken leg.

Colin Harvey's managerial reign at Everton ended after a 2-1 defeat by Sheffield United at Bramall Lane - all the goals came after the break: Carl Bradshaw, Brian Deane and John Pemberton putting past his own 'keeper.

In the final fixture on Tuesday, Tottenham, led by Gazza, got the better of Bradford at White Hart Lane,

2-1 after going behind to a Gavin Oliver goal. Paul Gascoigne and Paul Stewart sealed "Spurs" success.

Tony Cascarino and a David Platt penalty were on target for Aston Villa at home to Millwall - the Midlands side 2-0 winners.

Chelsea and Portsmouth shared in a goal-less draw at Stamford Bridge.

Coventry recorded a 3-0 victory over Hull at Highfield Road, thanks to second half goals by David Speedie, Jason Livingstone and Cyrille Regis.

While the Town drew nil-nil with Sheffield Wednesday at Hillsborough, Swindon's next potential opponents, Derby, thrashed Sunderland 6-0 at the Baseball Ground with a Mick Harford hat-trick, Gary Bennett own goal and two further efforts from Craig Ramage.

Last year's beaten finalists, Oldham, lost 2-0 at Leeds, Lee Chapman and Gavin Speed were on the scoresheet.

Manchester United made the headline news with the first defeat of Liverpool since April, 3-1 at Old Trafford. A Steve Bruce penalty and Mark Hughes did the damage within 60 seconds. Lee Sharpe added a third, Ray Houghton replied.

West Ham suffered their first defeat in seventeen matches, 2-1, after taking the lead at Oxford through Trevor Morley. Martin Foyle equalised, before Jim

SHAUN HODGETTS OF GWR FM WITH HIS "IN-DEPTH" LOOK AT THE FOOTBALL SCENE

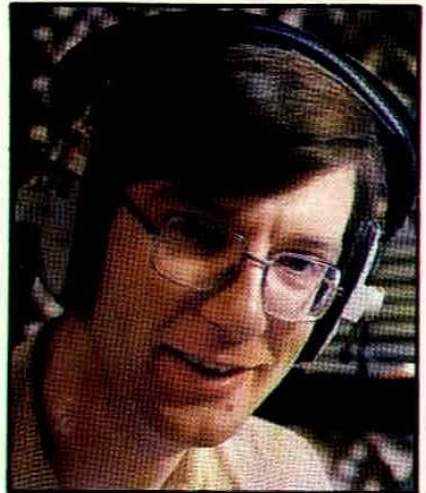

Magilton's last-gasp goal.

Nottingham Forest are now 22 matches unbeaten in this competition and have scored fifty goals in that sequence. Garry Parker and Nigel Jemson gave them the advantage at Plymouth. Argyle's marksman was Dennis Salman in their 2-1 loss at Loftus Road.

It was Queens Park Ranger's 2, Blackburn 1. Mark Falco started the scoring, Keith Hill levelled and then former Rovers' forward Simon Barker opened his account for the season for QPR with the decisive goal.

That's how the sixteen sides (plus two extra) have progressed so far. Let's hope Ossie's red and white army make their march all the way to Wembley.

LEMON & CO

SOLICITORS

*A SUBSTANTIAL PRACTICE ABLE TO
PROVIDE ADVICE & HELP IN ALL
ASPECTS OF COMMERCIAL & PRIVATE LIFE
AND INCLUDING A FRIENDLY, THOROUGH
AND PROFESSIONAL CONVEYANCING
SERVICE*

Richard Fry, Timothy Dixon, Deirdre Moss
34 Regent Circus
Swindon SN1 1PY
Tel: SWINDON 527141
FAX: SWINDON 614168

Martin Evans, Stephen Moss
148 High Street
Wotton Bassett SN4 7AB
Tel: SWINDON 853665
Fax: SWINDON 850324

Richard Challis, David Halfhead
1 Little London Court
Old Town, Swindon SN1 3HY
Tel: SWINDON 527141
Fax: SWINDON 511639

SWINDON T O W N

CLUBCALL

0898 12 16 40

AVAILABLE FROM ANYWHERE IN THE U.K.
7 DAYS A WEEK 52 WEEKS A YEAR

SWINDON

CLUBCALL

Calls cost 33p/minute cheap; 44p/minute other times.

BT Supercall, 1-9 Downham Road, London N1 5AA.

 SUPERCALL

CONGRATULATIONS

To Alan McLoughlin who has once again been included in The Republic of Ireland Squad for their forthcoming European Championship qualifying match against England in Dublin on Wednesday 14th November.

Alan is now a regular member of Jack Charlton's squad, and hopefully will add to his tally of caps next week.

★ ★ ★

COMMISERATIONS

To David Kerlake who, after being sent off in our match with Leicester City, starts a three match suspension after our replay with Sheffield Wednesday and misses our forthcoming matches with Portsmouth, Notts County and the (away League) fixture with Sheffield Wednesday.

★ ★ ★

TOWN END HOME OR AWAY?

Many of you are probably wondering why after the announcement that the "Town End" would revert to home fans use, it is now given over to Sheffield Wednesday supporters.

The answer is quite simple, under the rules of all Cup competitions the home club have to make available to the visiting club 25% of all accommodations both seating and standing.

The South Side corner ("The Wedge") takes care of the standing capacity and the "Town End" meets the rules of the competition regarding seating for visiting clubs.

For Barclays League Division Two matches, the "Town End" will revert to home fans.

INJURY SITUATION EASING?

September and October has seen our First Team squad decimated. David Kerlake sustained a nasty foot injury against Bristol City and missed three matches. Then Colin Calderwood was carried off against Wolves with severe ligament damage. Worse was to follow when new signing Dave Bennett was laid low when breaking his leg at Darlington. Alan McLoughlin missed the first three matches whilst Steve White's back trouble kept him on the side lines until late September. Steve Foley missed a couple of matches and to crown it all both new signings, Argentinian International Nester Lorenzo and Micky Hazard, who joined us from Spurs, were both laid low with injuries, that meant they have missed important matches. Duncan Shearer and Jon Gittens also missed matches through injury. Hopefully the situation can only get better and Ossie will soon have most of the walking wounded available for selection, Kevin Morris will be able to relax a little and we shall start to climb up the Division Two table.

★ ★ ★

**SWINDON TOWN F.C.
ANNUAL CAROL SERVICE**
Thursday 13th December 1990
at the Central Church Swindon
(new premises)
at 7.30 p.m.
Collection for Respite Charity.
Players, Director and
Club Officials take part.
All supporters welcome.

VIDEOS

**Swindon Town v. Sunderland
Wembley 28th May 1990
Play-Off Final**

Videos still available exclusively from The Commercial Department, Swindon Town F.C., County Ground Swindon.

Price £20.00, postage and packing £1.25 extra or can be collected.

Videos of all home matches are also available from The Commercial Department. Price £11.50 plus £1.25 postage and packing or can be collected.

★ ★ ★

TO ALL FORMER NATIVES OF NOTTINGHAM

Nottingham City Schools Football Association is celebrating its centenary in 1991. Did you ever represent the Association (City Boys) at any level U-11 to U-16. If so, we'd like to hear from you and add your name, address and telephone number to our register so that we can include you in our celebrations in 1991.

So far, we have contacted many players, some even in their 80's. We don't mind how young or old you are - please contact: Mr Peter Holmes, 16 Radcliffe Gardens, Carlton, Nottingham NG4 1SB.
Tel: (0602) 874771.
Thank you.



**CALL THE RADIO LINE FOR THE
LATEST SPORTS NEWS 24 HOURS A DAY
ON 0898 333000** Calls charged at 33p/min peak/25p/min all other times

BETTER BUY BURMAH

Burmah Petroleum Fuels Limited
is proud to support Swindon
Town Football Club and offers a
warm welcome to all supporters
at:

Swindon Autopoint
Marlborough Road, Swindon

Newport Street Autopoint
Newport Street
Old Town, Swindon

Stratton Autopoint
67 Bridgend Road
Stratton St Margaret, Swindon

St. Margarets Garage
Highworth Road
Stratton St. Margaret, Swindon

Blagrove Autopoint
Great Western Way, Swindon

Bath Road Autopoint
Bath Road
Old Town, Swindon

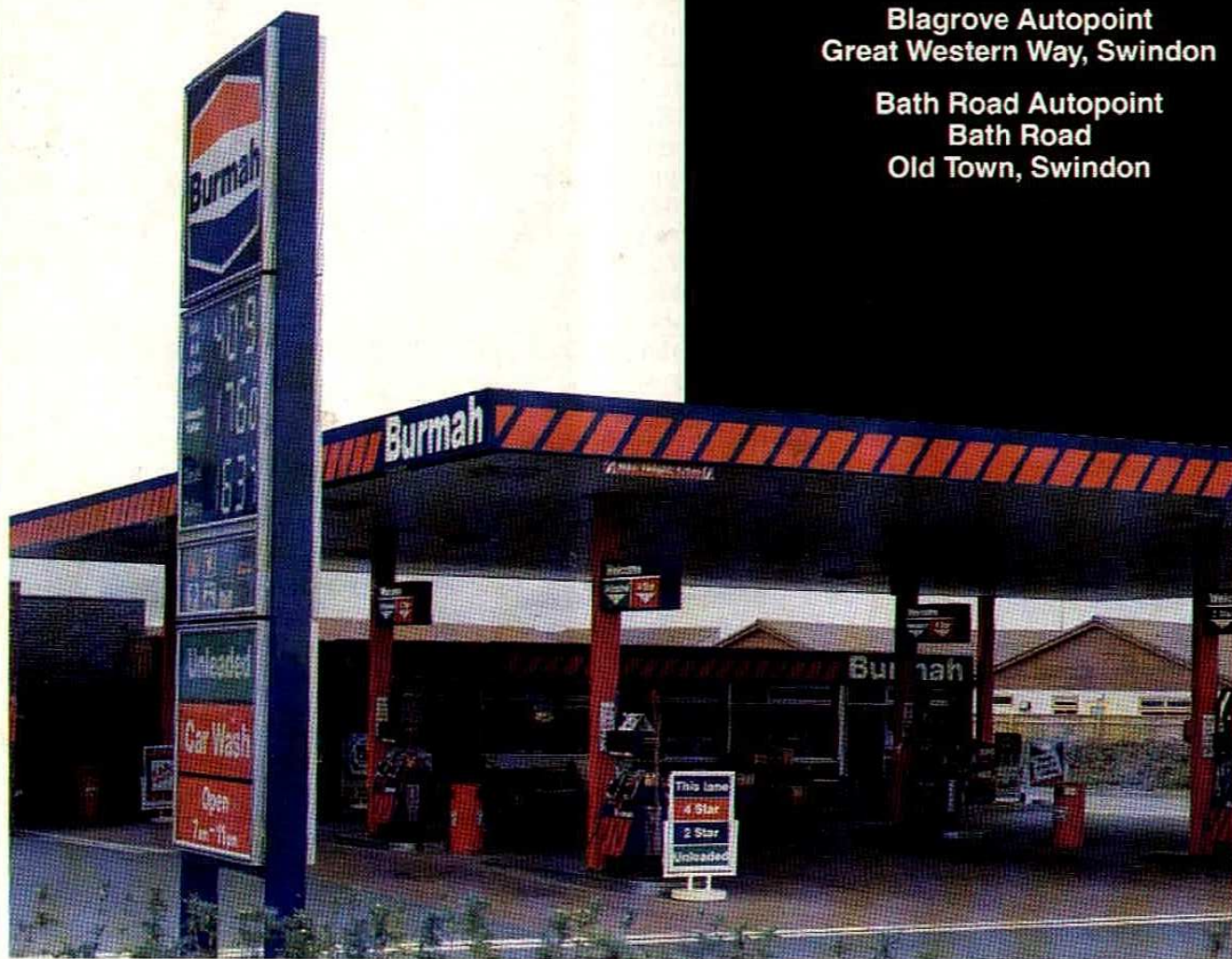

*Look out for the Burmah
Footballs kicked into the
crowd at every home match!*



ELECTRONIC SCOREBOARD

We can now provide a message service for our fans, and pass on birthday greetings, announce engagements, weddings, births, etc. To be featured on the Scoreboard, once before the game and again at half-time, costs only £10.

You can select your match and also your message.

Just send your message and cheque for £10, payable to: Swindon Town FC, The Commercial Department, Swindon Town F.C., County Ground, Swindon Wilts. Or complete the form below:



I wish to advertise on your Electronic Scoreboard, and enclose cheque for £10 payable to Swindon Town F.C.

Name:

Address:

Tel No:

Date of Match:

Message as follows
(not more than 10 words):

.....

30 things you probably didn't know about...

Steve White

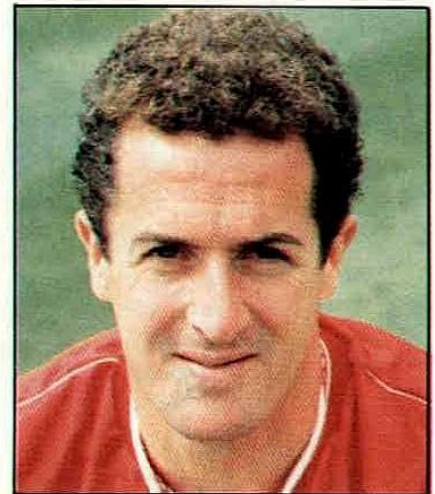

- Steve was born in Chipping Sodbury
- He and his wife, Amanda, live in Chipping Sodbury, Bristol.
- They have a pet dog called Cherieé.
- He has one child, named Joseph.
- As a boy he supported Manchester United.
- He lists his favourite players as Johann Cryuff, Pele, George Best, Bryan Robson, Gary Lineker and Steve Bull.
- His ambition while at school was to be a footballer.
- One of his favourite subjects at school was mathematics.
- He gained 8 'O' levels and 2 'A' levels.
- He collects stamps.
- His favourite food is fillet steak.
- His favourite chocolate is Mars bars.
- He likes poached eggs on toast as a pre-match meal.
- He reads the Daily Mail.
- He likes to play tennis and golf in his spare time.
- His father was the biggest influence on his career.
- He made his League debut in 1978.
- He does not enjoy flying.
- When he retires from playing he would like to stay in the game in some capacity.
- His favourite holiday spot in this country is Cornwall.
- His favourite comedian is Billy Connelly.
- He dislikes the offside rule.

- He drives a Porsche, but would like to drive a Lada, Riva or Skoda!!
- His favourite TV programme is Only Fools & Horses.
- The person he would most like to meet is the Queen.
- He wears Nike boots.
- He names Jimmy Greaves as his favourite football expert.
- His favourite singer is Johnny Mathis.
- He describes his most embarrassing moment on a football field was when Emlyn Hughes persuaded a referee to send him off.
- He has a 100% penalty record, he has never taken one!

McLEAN HOMES. BUILDING FOR EVERYONE'S FUTURE

McLean's superbly built homes are ideal for
the 1990s.

Whether it's a 1-bed starter apartment, or a
magnificent 4-bed executive home, the quality
is outstanding.

And we'll keep building for everyone's future,
right into the 21st century.

McLean
CREATIVE BUILDERS

McLean Homes South West Limited, Omicron, Windmill Hill Business Centre,
Swindon, Wilts. SN5 9YU. Tel: (0793) 874700.



WALKER JACKSON

IVECO
Ford
TRUCK

Ford
MOTORSPORT

Get a fresh start to motoring this season



ALL PRICES
ARE
INCLUSIVE
OF VAT



Check Ford First.



A 4.546 LITRE CAN 10/30, 20/50, OR 15/40 SF/CD
MULTIGRADE FORD OIL PLUS FILTER
TO FIT FORD KL, OHC, BL AND V
ENGINES, ALSO SOME ALFA-ROMEO,
FIAT, LADA, LANCIA, PEUGEOT,
RELIANT, RENAULT, SAAB, TALBOT,
TOYOTA AND VOLVO ENGINES

TECHNOLOGY TELLS...
NEW SUPER COPPER
CORE SPARK PLUGS
FROM MOTORCRAFT

£4.00

(SET OF 4 - INCLUDING VAT)



£6.50

INC. VAT



OPEN ALL DAY SATURDAY

ALL PRICES INCLUDE VAT



Walker Jackson & Co. Limited
CAR PARTS
Marlborough Road
Tel: Swindon 695702

Walker Jackson & Co. Limited
VAN AND TRUCK PARTS
Coped Hall, Wootton Bassett
Tel: Swindon 850225

PARTS CENTRE
OPEN SIX DAYS A WEEK
Monday to Friday
8am - 6pm
Saturday 8.30am - 5pm
PARTS CENTRE
OPEN SIX DAYS A WEEK
Monday to Friday
8.30am - 6.30pm
Saturday 8.30am - 3.30pm

THE ROBINS CORNER

CHRISTMAS 1990

		P.&P.
APRON PVC (White)	£ 5.00	.50
ASHTRAY	£ 2.00	£ 1.00
BABYWEAR		
Bibs (Various Colours)	£ 1.00	.25
Sleep Suits (Various Colours)	£ 4.99	.45
BADGES		
Enamel (5/8")	£ 1.50	.25
Enamel (Round)	£ 1.60	.25
Enamel (Shield)	£ 1.75	.25
Embroidered	£ 1.20	.25
BATHROOM TIDIES Soap/Toothbrush	99 ea	.25
CAPS		
Flat	£ 3.00	.25
Jockey (Adults)	£ 3.50	.35
(Childrens)	£ 1.75	.35
Waterproof 'Football'	£ 4.95	.35
CAR STICKERS (Various)		
'Turtle'	£ 1.00	.25
'Swindon Town on Tour'	£ 1.25	.25
'Swindon Town on Tour'	£ 2.95	.25
CERAMIC DOOR TILE		
'Supporters Room'	£ 1.50	.25
CLOCKS		
Travel	£ 3.99	.25
Wall (batteries not included)	£ 9.50	.75
COASTERS Leather (cork backed)	£ 1.20	.25
FOOTBALLS		
Swindon Town Mini Ball	£ 3.50	.50
Trophy (Vinyl)	£ 7.50	£1.00
Various Match Balls	£12.00 to £86.00	£1.00
GLASSWARE		
One Pint Tankard	£ 2.50	Not suitable
Half Pint Tankard	£ 1.95	for posting
One Pint Nonic (Straight Glass)	£ 1.50	
Miniature Glass	.75	
GLOVES		
Mens or Youths	£ 2.50	.25
Boys	£ 1.75	.25
HATS		
Bob	£ 3.20	.35
Ski (Red or White)	£ 3.00	.25
JACKETS		
Body Warmers	£10.50	£1.00
Lightweight (Red or White)	£25.00	£1.00
Bomber (Grey only)	£22.50	£1.50
¾ Length (Blue only)	£26.50	£1.50
JOGGING PANTS	£11.50	£1.00
KEY RINGS Various from £1.00 to	£ 2.50	.25
6-Ring Case	£ 2.50	.30
KIT BAG (Nylon) (Red)	£ 7.95	.60
MUGS	£ 2.00	
(also 'On Tour' 1990/90)		

WE TAKE

Access • Visa • Eurocard • Master Card

*Cheques should be made payable to
Swindon Town Sports*

		P.&P.
OFFICE/SCHOOL		
Bookmark (Leather)	£ 1.00	.25
Desk Tidy	£ 1.99	.35
Desk Tidy Gift Pack	£ 2.99	.45
Eraser	.35	.25
Pen	.45 or .60	.25
Pencil (Red or White)	.25	.25
Pencil Case (Red or White)	£ 1.00	.25
Pencil Sharpener	.35	.25
Ruler	.75	.25
PENNANTS		
Car	£ 1.50	.25
Large	£ 3.50	.25
PHOTOGRAPHS		
Individual Players	£ 1.00	.25
Team	£ 2.85	.25
'Wembley 1990' Framed	£30.00	N/A
REPLICA KIT		
Shirts	from 22"/24" up to 48" £17.00 to £30.00	.50
Shorts	from 5.35 to £ 8.35	.50
Socks	from £2.35 to £ 3.15	.50
ROSETTES	£ 1.30	.25
SCARVES		
Acrylic	£ 3.50	.45
Acrylic 'Ossies Army'	£ 2.85	.35
Jacquard	£ 3.50	.45
Scarf with Pockets	£ 6.00	.45
Polo Neck Insert	£ 3.50	.35
Ladies Headsquare	£ 5.50	.25
SHIRTS		
Polo/Leisure	£11.50	.70
'Ossie Ardiles' Rugby Style	£18.50	£1.00
Quartered Rugby	£17.50	£1.00
Patch Design Sweatshirt (Black)	£15.50	£1.00
Childrens	£12.00	.60
Tri-Colour Sweatshirt	£17.50	£1.00
'Turtle' Sweatshirt	£15.00	£1.00
Childrens	£12.00	.60
Childrens Sweatshirt	£12.50	.60
SUIT COVER PVC (Maroon)	£ 6.50	.50
SWEATERS		
Acrylic V Neck	£14.50	£1.00
Cuortelle V Neck	£18.00	£1.00
Childrens	£16.95	.60
T SHIRTS		
Play-Off Winners	£ 6.50	.50
UK Tour 1990/91	£ 6.50	.50
'Turtle'	£ 6.50	.50
TIES (Grey or Navy)	£ 5.95	.25
TOWELS	£ 5.50	.70
UMBRELLAS		
(Red/White, Yellow/Blue)	£17.50	£1.50
UNDERWEAR		
Boxer Shorts (Large only)	£ 5.99	.35
Ladies Briefs	£ 2.50	.25
WRISTLETS	£ 1.00	.25

Shop Opening Hours:

	Mon.-Fri.	Sats.	Suns.
Non-Matchdays	09.30 - 16.30	09.30 - 16.30	Closed
Home Matchdays	09.30 - 19.30	09.00 - 14.45	10.00 - 14.45
Away Matchdays	09.30 - 12.00	Closed	Closed

'The Robins Corner', Swindon Town F.C., County Ground, Swindon, Wilts.

Tel: (0793) 430430



Top: Swindon Town manager Ossie Ardiles pictured with Spanish youngsters, from the left, James, Javier, Juan Jose, Davie and Asier, during their visit to the County Ground.

Bottom: Micky Hazard receiving his Sony Teletext Television as his award for being selected Man of the Match in the Rumbelows Cup game with Darlington recently. Micky then presented the television to the Princess Margaret Hospital Childrens Ward.



AKERS GARAGE LTD.

MAIN VAUXHALL CAR AND LIGHT COMMERCIAL DEALER

VAUXHALL - VAUXHALL - VAUXHALL - VAUXHALL

VAUXHALL - VAUXHALL - VAUXHALL - VAUXHALL

CAR/VAN SALES NEW & USED

Service Department M.O.T. Testing Station

BODY & PAINT REPAIR SHOP

Genuine Vauxhall Spares

SELECTION QUALITY USED VEHICLES

AKERS

YOUR LOCAL VAUXHALL CAR AND LIGHT COMMERCIAL DEALER

THE STREET, MOREDON, SWINDON SN2 3ES

Tel: (0793) 523457/8/9



VAUXHALL

SERVICE - PARTS - SALES - SERVICE - PARTS - SALES - SERVICE - PARTS - SALES - SERVICE



SILVER KNIGHT

THREE LEVELS OF SERVICE
TO CATER FOR ALL NEEDS

★ VIP EXECUTIVE ★

★ LUXURY ★

★ GENERAL/CONTRACT ★

UK and CONTINENTAL CHARTER for BUSINESS and PLEASURE

All Silver Knight Coaches are of a high standard
You will receive the same efficiency whichever you choose

For our VIP/Executive service,
our drivers wear tailormade suits to fit the occasion

Your comfort will be guaranteed with

Reclining Seats - Curtains - Tables - Toilet/Washroom - Hot/Cold Drinks
Fridge - Servery/Bar - Video - Telephone - Hostess/Guide

Silver Knight Coaches Ltd., Christian Malford, Chippenham, Wilts. SN14 5BH
Telephone: (0249) 720360

FOR COACH TRAVEL SUPREMACY

Match & Ball Sponsors

Date	Opponents	Match Sponsor	Ball Sponsor
Tues. Sept. 28	Ipswich Town	Redman Sheet Metal	Hinders of Ermin Street, Swindon 824725
Sun. Sept. 2	Bristol City	The Plumb Center	Dave Smith, A Town Fanatic.
Sat. Sept. 15	Middlesbrough	Crosby Doors Ltd.	Peter Godwin, An ex-Swindonian now residing in Harrow
Tues. Sept. 18	Wolverhampton W.	M.S. Group, Swindon	Blunsdon House Hotel
Sun. Sept. 30	Millwall	Metalite Engineering	Mr. A. Raynor, Uni Mill Engineering
Tues. Oct. 9	Darlington	Blunsdon House Hotel	
Sat. Oct. 13	Bristol Rovers	Roy Allen Supplies	Hammond Construction, Highworth, Swindon 766112
Sat. Oct. 20	West Ham United	Arkells Brewery	Brize Norton Garages, Carterton
Sat. Nov. 3	Port Vale	Clarion Shoji (UK) Ltd.	Mr. J. Tremlin, Coped Hall Service Station
Tues. Nov. 6	Sheffield Wed.	Sir Seton Wills & Family	Edward & Trevor Howard of Fairford
Sat. Nov. 10	Portsmouth	Multi Agg Quarries	Travers Morgan & Partners, Consulting Engineers
Sat. Dec. 1	Blackburn Rovers	Mr. Clive Sharples	Data Call Systems Ltd, 78/86 Pennywell Road, Bristol BS5 0TR
Sat. Dec. 15	Charlton Athletic	McLean Homes Ltd.	Hayman & Partners, Swindon
Sat. Dec. 22	West Bromwich Albion	Swindon Calor Gas	Flow Forms Ltd. (Wiltshire)
Tues. Jan. 1	Plymouth Argyle	John Coyle Services	Cliff Jones, Wessex Conservatories
Sat. Jan. 19	Hull City	Colson Engineering	The Peter Allen Traditional Jazz Band
Sat. Feb. 9	Oxford United	Oxford and Swindon Co-Operative Society	Mr. Gerry Williams, Ring Cafe, Cavendish Square
Sat. Feb. 16	Sheffield Wed.	Heywood Insurance Melksham	Wilson Tool International Ltd.
Sat. Mar. 9	Notts. County	Power Plant Hire Ltd.	Calne Town F.C.
Tues. Mar. 12	Oldham Athletic	Action Plant Hire	Emery McLaven Orr
Sat. Mar. 23	Brighton & H.A.	Skurrays Ltd. of Swindon	Mr. Paul Plowman
Sat. Mar. 30	Newcastle United	Hammond Construction Highworth	Mr. T. Harris, The Falcon Inn, Swindon
Sat. Apr. 6	Watford	F. Green & Sons of Lambourn	Mr. Piper & Friends, Swiss Chalet
Sat. Apr. 27	Leicester City	McLean Homes Ltd.	Baker Bros. Builders, Lambourne
Sat. May 4	Barnsley	Clarion Shoji (UK) Ltd.	Titcombe Garages, 24 Hour Breakdown Service, Swindon 641643

On the road to Sheffield

Saturday November 17th 1990

Kick-Off 3.00 p.m.

Route

Proceed to M1 via usual Oxford A420 route. Follow M1 to Junction 31 or 31 and proceed into Sheffield on A6109.

Take third exit from roundabout, A610, into Prince of Wales Road.

Turn left into Herries Road South for Hillsborough.

Parking Information

Street parking.

Nearest Railway Station

Sheffield Midland.
Tel: (0742) 26411.

Plan of Hillsborough

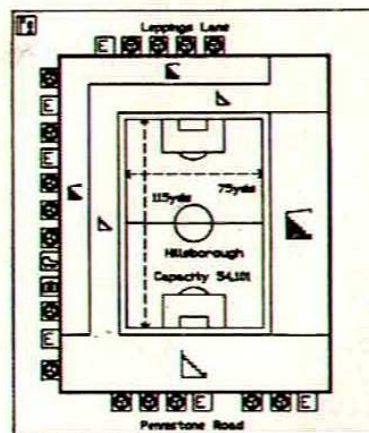

GWR FM 97.2

THE INFORMATION STATION

Match Action



Top: Fitzroy Simpson in Determined mood at Hillsborough last Wednesday.

Bottom: Fraser Digby punches clear under pressure at the Leppings Lane end at Hillsborough.

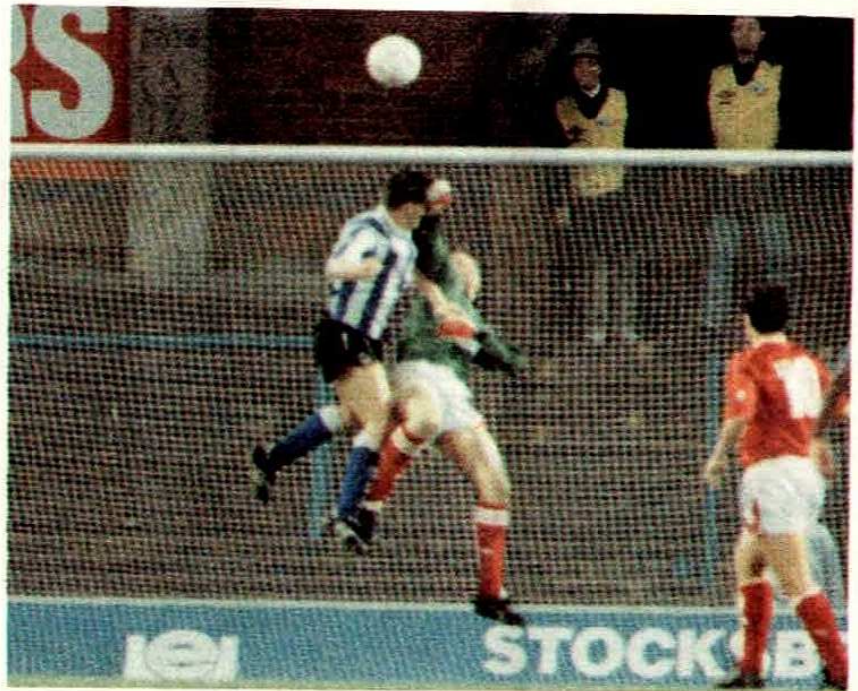

GWR FM 97.2

FIRST FOR SPORT

THE FOOTBALL LEAGUE CUP'S BEEN RUMBLED.

**RUMBELOWS
LEAGUE CUP**



**21/23 High Street
Chippenham**

**77 Regent Street
Swindon**

**RUMBELOWS ARE THE OFFICIAL SPONSORS
OF THE FOOTBALL LEAGUE CUP.**

Visit your local Rumbelows for details of our special offers throughout the season.

OVER 100 CARS TO
CHOOSE FROM - LATEST
MODELS AVAILABLE,
SALOONS, HATCHBACKS,
ESTATES, AUTOMATIC,
SPORTS, PRESTIGE CARS

- RADIOS
- CHILDSEATS
- ROOF RACKS
- & TOW BARS

SPECIAL DISCOUNTS FOR LONG TERM HIRE

DELUXE CAR HIRE

FULL AA RELAY
COVER
NO MILEAGE
CHARGE
DELIVERY &
COLLECTION
AVAILABLE



AFTER HOURS
SWINDON
531205

11 MARLBOROUGH RD, SWINDON

SWINDON 644996

NO HIDDEN EXTRAS
WE QUOTE ALL IN
PRICES

OPEN 7 DAYS A WEEK

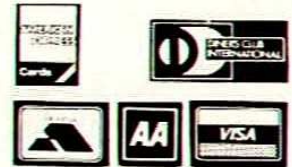

BAMPTONS



STRATTON ROAD,
SWINDON,
WILTSHIRE.

TEL: (0793) 35547/8/9

MOTOR VEHICLE ACCIDENT REPAIR SPECIALISTS

Approved by Major Insurance Companies



Motor
Agents Association

ZENITH DATA SYSTEMS CUP 2nd ROUND

Chelsea v Swindon Town at Stamford Bridge

Wednesday December 12th, Kick-Off 7.30 p.m.

Ticket information to follow.

This tie has been brought forward one week by mutual agreement of both clubs.

DELAYS ON THE M1

There will be considerable delays on the M1 Motorway from Friday 16th November 1990.

If you are going to Hillsborough please allow extra travelling time on 17th November 1990.

ZENITH DATA SYSTEMS CUP IS LIVE ON SKY

Sky TV have confirmed live coverage of three Zenith Data Systems Cup ties. The games, which kick-off at 7.35, will be shown on the Sky One channel, as follows:

Tuesday 20 November	Middlesbrough v Hull City
Tuesday 27 November	Leicester City v Wolves
Tuesday 18 December	Sheffield Wednesday v West Bromwich Albion or Barnsley

SHRIVENHAM ROAD/FAMILY ENCLOSURE

There have been a number of complaints about supporters not being able to gain access to the above terrace when there appears to be plenty of space for spectators to stand.

The answer to this problem is that under the safety certificate issued by the Wiltshire County Council Safety Committee the total number of spectators allowed in this area is 2,630.

With 1000 season ticket holders guaranteed entry to each match, that leaves 1,630 spaces for paying customers on the day of the match. When the total of 1,630 has been reached then the turnstiles have to be closed. This is the law.

If you do arrive at the Shrivenham Road/Family Enclosure and the turnstiles are closed, then please come along to the Stratton Bank or Town End (League matches only) where you should be able to gain entry to the match.

TONIGHT'S WINNERS

The winners of tonight's match will be at home to Derby County week commencing 26th November.

If the scores tonight are level after 90 minutes then 30 minutes of extra time will be played. If the scores remain level then a replay will be arranged.

Swindon Town F.C.
The County Ground
Swindon
Wilts.

Dear Sirs,

Please find enclosed a recent photo of myself (right) and my friend Peter Thomas (left) at Hwange Safari Park in Zimbabwe.



I wonder if you might consider the photo for publication in your excellent match programme.

Peter is working as a teacher for two years at Centenary in Zimbabwe and I went out to visit him and for a holiday.

We are both keen Swindon fans and Peter relies on the BBC World Service to keep himself up to date with how the "Town" are doing. Like all Swindon fans he was delighted when we won at Wembley and very dejected when we were demoted by the Football League. (Of course, Pete couldn't make the game at Wembley as he was already out in Zimbabwe at that time).

We both hope that when Pete returned to the U.K. in January 1992 the "Town" will be back in the First Division.

Yours faithfully
Andy Day

TRAVEL CLUB NEWS

The Travel Club is now booking for:

Sheffield Wednesday	
17th November	Depart 9.30 £7.50
Notts County	
24th November	Depart 10.00 £6.00
Ipswich Town	
8th December	Depart 9.10 £8.00

The Boxing Day trip to Newcastle will leave the County Ground at 7.00 a.m. (to be confirmed), we will be grateful to know how many of you intend to travel on this *Festive Special* as soon as possible.

Now for some good news. The *Travel Club Office* should be ready for us to return in the next two weeks, we are sorry for any inconvenience caused to members.

The Travel Club Committee would like to extend grateful thanks to Kevin Gray of Swinon ITEC for his help with the computer.

Please book early for all trips and remember that there is only one Official Travel Club, so if you aren't yet a member *don't delay, join today* and support your team. Telephone or call Tuesday, Wednesday or Thursday evenings, 7.30 - 10.00 p.m. Swindon 611499 or any any other time on (0453) 883051.

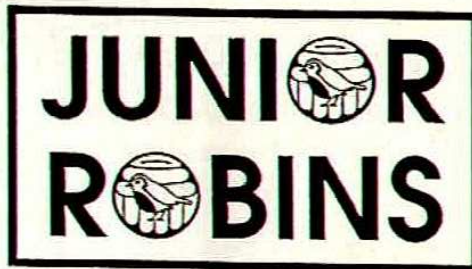

Portsmouth will be providing our next opposition, please ring Swindon 430430 ext. 207 for further details regarding this match, let's hope we will have a great day.

Can you find the names of some of your favourite players in these anagrams:

1. RIB FADS GREY
2. HEN SEA CARD RUN
3. SENT JOG TIN
4. VET WITH SEE
5. CORD LOAN WIN COLE

Post your answers to Mrs. J. Moore, Commercial Department, S.T.F.C., The County Ground, Swindon, Wilts. by Monday November 12th. A draw will take place on Tuesday November 13th and the first three correct entries drawn will receive a free copy of our "Day to Remember" Wembley video.

As part of our commitment to improve and expand the Junior Robins Club, we are having very positive talks and negotiations with "McDonalds", Barclays Bank, Cannon Cinema and the Evening Advertiser and we are sure that when all our plans come to fruition our members will benefit greatly.

YOU SUPPLY THE TALENT MITRE SUPPLY THE REST !



 **mitre**
F O O T B A L L



MITRE ARE THE SOLE MANUFACTURER & SUPPLIER TO THE ENGLISH FOOTBALL LEAGUE
OF THE EXCLUSIVE DELTA DESIGN OFFICIAL MATCH BALL.

Kit Sponsors

FRASER DIGBY
 A. Mr and Mrs Fisher, Birdcombe Walk
 B. Mrs Chilcott, Ash Walk, Warminster
 C. The Brown Family, Carterton
 D. Alexander Independent Financial Advisors
 E. S.T.F.C. Skittles Team, Stonehouse

OSSIE ARDILES
Swindon Supporters in London
 Contact: Nick Coote 081-828 1437
 Paul Donkersley 081-870 0316
 David Moulard 081-347 9845
 Complete kit

COLIN CALDERWOOD
 A. Mr and Mrs Peet, White Hart, Oare
 B. Mr Tim Barnes, Ashton Keynes
 C. R. & K. Owen, Friesian Close, Swindon
 D. Roland, Nigel, Sam Jones & Peggy Postma
 E.

NICKY HAMMOND
Modular Marquees
 (06667) 246
 and
Mr Jonothan Powell
 Complete kit

MICKY HAZARD
Marchants Contract Cleaning
Britannia Lift Services (U.K.)
 Complete kit

SHAUN CLOSE
 A. Compton Welding, Purton 770742
 B. V.G. Newman, Lea, Malmesbury
 C. John Ward, New Farnley, Leeds
 D. Tudor Carpets, Seymour Rd., Swindon
 E. Jefferies D.I.Y., High St., Highworth

DAVE BENNETT
 A. Mr and Mrs Tucker of Seend
 B. Mr Piper and Friends, Swiss Chalet
 C. Mr and Mrs Fisher, Birdcombe Walk
 D. Bryant School of Motoring: 823421
 E. Colin Aldridge, Highworth



PAUL BODIN
Mr K. P. Emms
Mary Hewer Take Away
Groundwell Road
Swindon
 Complete kit

 **TOM JONES**
*"I bet he drinks
 Carling Black Label"*
 Complete kit ▲ Bass

NICKY SUMMERBEE
Sir Seton Wills
 Complete kit

JON GITTENS
Wessex
Conservatories
 Complete kit

DAVID KERSLAKE
Haine & Smith
Opticians
Marlborough, Swindon, Highworth
 Complete kit

ROSS MACLAREN
 A. John Tremlin, Coped Hall S. Station
 B. Terry Wollen, Wollens Off Licence
 C. Lynne Stevens, Warminster
 D. Rebecca Vockins, Highworth
 E.

DUNCAN SHEARER
Bassett Bookmakers
 Complete kit

ALAN McLOUGHLIN
 A. John Harris, Westcott Place P.O., Swindon
 B. Alexander Independent Financial Advisors
 C. Keith Chilcott, Warminster
 D. Sandra Coburn
 E.

FITZROY SIMPSON
Clare Catering of Oxford
 Complete kit

KEVIN MORRIS
 A. Geoff James of Banbury
 B. Mr Maurice Earle
 C.
 D.
 E.

STEVE WHITE
Multisets
For all Computer Stationery
 Tel: (0793) 729500
 Complete kit

ADRIAN VIVEASH
Raynor and Sons
Vehicle Dismantlers
Broad Town, Swindon
 Tel: Swindon 863715
 Complete kit

PAUL HUNT
TS TYPESETTING
 Typesetters of the official
 S.T.F.C. matchday programme
 Tel: (0793) 618505
 Complete kit

STEVE FOLEY
 A. Mrs Chilcott, Warminster
 B. G. Mulcahy, Wills Club, Swindon
 C. R. and J. Warren of Lambourne
 D. Jason & Duncan Malcome, Bulford
 E.

ANDY ROWLAND
 A. R. K. Owen, Friesian Close, Swindon
 B. Chris Weavers, Haydon Ct., Swindon
 C. A. Pegler & H. Mahoney, Kempsford
 D.
 E.

TONY GALVIN
The Robins Out Of Town
 Complete kit

CHIC BATES
Julian Wilson
 Complete kit

JOHN TROLLOPE
Nationwide Anglia
Building Society
 Complete kit

Key: A = Shirt. B = Boots. C = Tracksuit
 D = Training Kit. E = Shorts/Socks.



FOR SPORT, NEWS, INFORMATION AND ENTERTAINMENT 24 HOURS A DAY, CALL THE GWR RADIO LINE ON 0898 333000

Calls charged at 38p/min peak/25p/min all other times

THE UNBEATABLE TEAM

DEACONS



PLUS

ROLEX

SALES
& SERVICE



DEACONS

(Established 1848)

11-13 WOOD STREET, SWINDON

Tel: 522072 and 527530

23 MARKET PLACE, TETBURY Tel: 52766



Hulford

Motors Ltd

SELF DRIVE HIRE SPECIALISTS
FOR OVER 30 YEARS

CAR & VAN HIRE



SPECIAL LOW LONG WEEKEND RATES



SHRIVENHAM ROAD, SWINDON

534934 & 524839

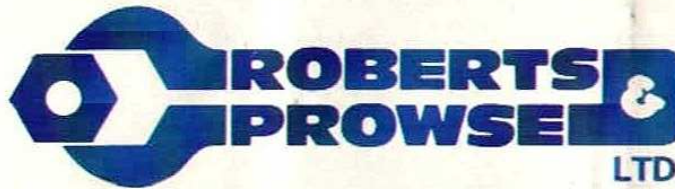

SPECIALISTS IN
LTD.

*Process Pipework and Plant, Building Mechanical Services,
Industrial Fabrication, Sheet Metalwork, Combustion Services, Thermal Insulation,
Asbestos Removal, Engineering Merchants, Development Engineers*

THORNHILL, SOUTH MARSTON, SWINDON SN3 4TA.

TELEPHONE (0793) 825505 FACSIMILE (0793) 822642



CASTLE'S

Office and Bakery

4 and 5 MARKET STREET SWINDON

Telephone 522017

Specialists

Wedding Cakes, Birthday Cakes.

Try our Wholemeal Bread and

Wiltshire Lardies and

Delicious Dairy Cream Cakes

ELEGANT

Reproduction Furniture

Luxury . . . you can afford



Qualities to suit all tastes . . .

Prices to suit all pockets . . .

Come and see for yourself at . . .

Howell's

Reproduction Furniture & French Polishing Specialists
52, DEVIZES ROAD, OLD TOWN



Swindon. Tel: 535658



TRANSPLANT

CONSTRUCTION MACHINERY RENTAL



Reading Depot:
Transplant Limited,
Toutley Works, Toutley Road,
Wokingham, Berkshire RG11 5QN
Tel: Reading (0734) 786278
Fax: (0734) 792820

South Coast Depot:
Unit 10, Fort Fareham Ind. Est.,
Newgate Lane, Fareham,
Hampshire PO14 1AH
Tel: Fareham (0329) 822453
Fax: (0329) 822502



Bristol Depot:
Transplant Limited,
Emery Road, Brislington Trd. Est.,
Bristol BS4 5PF Tel: (0272) 779211
Fax: (0272) 711559

Swindon Depot:
Gipsy Lane,
Swindon
Tel: (0793) 542266
Fax: (0793) 731600

BULK EXCAVATIONS
Six and Eight Wheel
Hinos. Hire on Daywork
or Priced Basis.

**NEW
SOUTH COAST
DEPOT**

POWERED AERIAL ACCESS EQUIPMENT

These items may be hired from any of our depots, but for specialist advice contact our Manager

THE FORCE IN PLANT HIRE

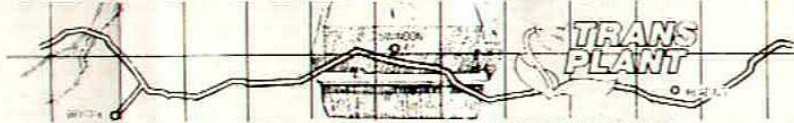

Head Office and Accounts Telephone: Swindon (0793) 731741

WALKER JACKSON

**Motoring...
we're on the
ball!**

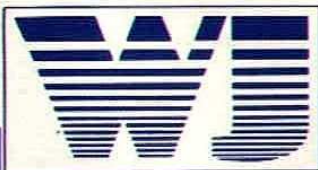

We're with you all the way!

Car Sales
Fleming Way
Roundabout
Tel: Swindon 20002

Car Service & Parts
Marlborough Road
Tel: Swindon 20002

Commercial Sales Service Parts
Coped Hall, Wootton Bassett
Tel: Swindon 853344



A Member of the Normand Group of Companies

Ten sound reasons for choosing a Wessex Conservatory.

Acknowledged experts: unbeatable quality. 1

Sturdy, durable: precision-engineered frame. 2

Superb choice of single or double glazed. 3

With toughened glass for extra safety. 4

Designed just the way you want it. 5



6 Clear-Shield easy-clean glass protection.

7 Planned and installed by trained personnel.

8 Super choice of blinds and other options.

9 Security locks and fittings standard.

10 Comprehensive 10 year Guarantee.

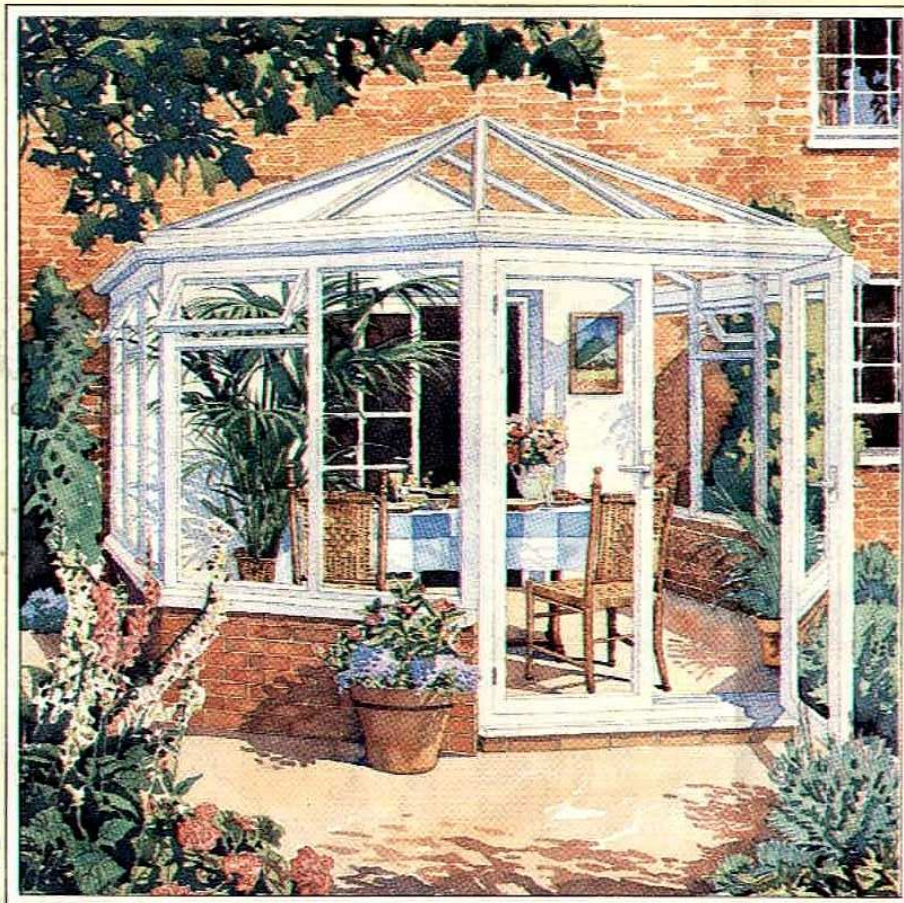

Available in
Classic White
or Havana Brown.

WESSEX CONSERVATORIES

Founder member of the Conservatory Association.

For free 20 page colour brochure send this coupon to:
Wessex Aluminium Ltd., Hawksworth, Swindon,
Wilts. SN2 1DZ
Or PHONE (0793) 644633

Please send me your FREE 20 page colour brochure
and details of my nearest Wessex dealer.

Name

Address

Phone No Ref. STFC



Reserves & Youths



Andy Rowland

RESERVES v TOTTENHAM
Saturday October 27th
Result: Lost 2-1

After the initial period of twenty minutes or so, where we allowed Spurs to dominate and dictate the play, our young reserve side really got to grips with the game and proceeded to give a very good account of themselves.

During that first period we conceded an early penalty which Philip Gray duly converted and Nicky Hammond was called on to make one or two excellent saves, but despite this pressure we held strong and gradually played our way back into the game. Before half time we had created several good openings, Paul Hunt forcing Mimms into a good save and Paul Trollope going close twice. Added to this having a perfectly good Hunt free kick disallowed, by the break we were full of confidence and running. It was no surprise, therefore, when we equalised shortly after half time, Nicky Summerbee scoring with a cracking shot on the run. Although we kept taking the game to Tottenham, we couldn't add to the scoreline and it was somewhat against the run of play when Spurs scored the

winner, Gray netting his second from a Mark Kelly cross.

This was an excellent team performance overall and as long as the lads play with the same confidence, commitment and self-belief throughout the season, we should have two or three more knocking on the door of the first team squad.

RESERVES v IPSWICH
Wednesday October 31st
Result: Won 3-1

Against a strong and experienced Ipswich side, we finally got the goals we deserved. Many times this season our excellent play hasn't been converted into goals so it was nice to sit back and relax as the ball hit the net three times. Paul Trollope (a fifth minute header), Robert Spence (slotting home from six yards) and Paul Hunt (a break from the half way line) did the damage, but it was a really good team effort over the ninety minutes.

Swindon dominated the early stages after taking the lead, but Ipswich, with the likes of Jason Dozell, David Lowe and Neil Thompson, gradually worked their way back into the game. Their goal came after thirty minutes when Lowe rode a couple of challenges to scoop the ball over Nicky Hammond's head.

Immediately after the break, however, Swindon really came out strong and scored twice in four minutes to put the game beyond Ipswich. Several more chances were created and missed, whilst the Ipswich front men rarely threatened our goal.

This was probably our best performance to date this season, fitting reward for a lot of hard work and enterprising play.

YOUTH TEAM APPEARANCES AND GOALSCORERS

	South East Counties League	South East Counties Cup	Southern Junior Floodlit Cup	F.A. Youth Cup	Midland Youth Cup
Ryan Lovegrove	3+1 0	-	-	1	1
Barry Williams	7	1	2	-	-
Darren Hall	3 1 p	1	2	-	-
Andrew Pitman	3	-	-	1	1
Edwin Murray	5	1	2	1	-
David Saunders	4	-	-	-	-
Andrew Thomson	9	1 1	2	1	1
Wayne O'Sullivan	9 3	1	2 1	1	1
Marcus Phillips	7 6	1	2 1	1	1
Robert Spence	8 3	1	2	1	1
Jason Braidwood	8	1	2	1	1
Murray Fishlock	9	1	1+1	-	1
Richard Boden	4+1 2	-	1+1	1	0+1
Mark O'Driscoll	1+4	-	-	-	0+1
Neil Pick	3	1	1	-	-
Glenn Jones	0+1	-	1	-	-
Andrew Bates	3	-	-	-	-
Neil Matthews	1 1	-	0+1	-	-
Jon Buchanan	3	-	-	1 1	1
Neil Skinner	0+2	-	-	-	-
Simon Sly	0+2	-	-	-	-
Andrew Madden	1+1	-	-	-	-
Gary Knight	1	-	-	-	1
Paul Chew	1	-	-	-	-
Lee Spalding	7	1	2	1	1
1 og					

SOUTH EAST COUNTIES LEAGUE
v READING
Saturday October 27th 1990
Result: Lost 5-1

Fielding our youngest side of the season, due to reserve team calls and injuries, we never settled into any kind of rhythm against a bigger and stronger side. Going behind early in the game did not help, but we equalised within minutes but conceded another goal soon after. Poor defending allowed Reading another goal before the interval to gain a 3-1 lead.

Working harder and giving more thought and care when in possession gave us more of the game but we conceded two headed goals through lack of challenge from crosses.

Out of defeat we must look for some signs that improvement is being made by the individual. Andy Thomson had his best game of the season while Ryan Lovegrove gave a promising performance as an outfield player.

The younger players will gain experience from sampling this standard of football and now know what is needed to play at this level.

F.A. YOUTH CUP
v BRISTOL ROVERS
Monday October 29th 1990
Result: Won 3-0

This was one of our better performances, with the right approach and working as a team. On top from the start, we soon took the lead when Wayne O'Sullivan cut back a low cross for Richard Boden to open the scoring. The rest of the first half was even, with both sides having a chance to score.

Bristol missed an early second half penalty, and soon after we went further ahead when Marcus Phillips volleyed in a half clearance from a corner. We made the game safe when Jon Buchanan fastened onto a bad back pass to round the 'keeper for number three. Robert Spence missed a late penalty but we already had the game won.

A good team performance, working hard for one another with Edwin Murray and Andrew Thomson strong in defence in front of a safe Ryan Lovegrove while Robert Spence led the front line well.



John Trollope

Statistics

GOALOMETER

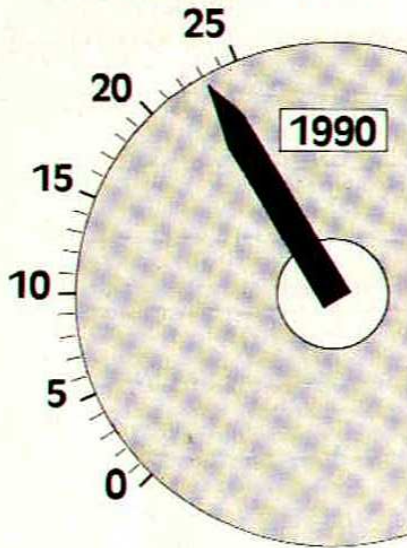

Swindon Town F.C. would like to thank the firms and individuals opposite for sponsoring every first team goal scored in competitive matches during season 1990/91.

SPONSORED GOALS

Abbey Road Garage, Cirencester
 M.S. Group, Swindon
 Clare Catering of Oxford
 Keith Lodge Industrial Roofing
 Metalite Engineering
 The Riverway Wine Company,
 Trowbridge
 Swindon Calor Gas Centre, Swindon
 Roy Allen Supplies, Swindon
 Brunel Scaffolding, Swindon
 Regal Windows, Swindon
 Skurrays, Drove Road, Swindon
 Thamesdown Cleaning Services,
 Swindon
 Multi Agg Quarries, Shellingford
 Les Smith Haulage, Swindon
 Moores Cars, Faringdon
 Carling Black Label
 Blunsdon House Hotel, Swindon
 Starlight Private Hire Cars, Swindon
 Western Daily Press
 Ashtons Auto's, Swindon
 Hammond Construction, Highworth
 High Close Soft Fruit, Hungerford
 Fisher Roofing, Link House,
 Highworth
 Biplob Tandoori Restaurants
 Swindon, Rodbourne, Highworth
 S. Coburn

BARCLAYS LEAGUE DIVISION TWO 1990/91

	P	W	D	L	F	A	Pts
Oldham Athletic	15	10	5	0	28	13	35
West Ham United	15	9	6	0	25	9	33
Sheffield W.	14	8	5	1	31	14	29
Millwall	14	7	4	3	25	15	25
Middlesbrough	14	7	3	4	23	12	24
Wolves	15	6	6	3	24	15	24
Barnsley	14	6	4	4	25	17	22
Notts County	15	6	3	6	21	19	21
Brighton & H.A.	14	6	3	5	24	28	21
Ipswich Town	15	6	3	6	18	23	21
Bristol City	13	6	2	5	20	22	20
Plymouth Argyle	15	4	7	4	16	17	19
Portsmouth	15	5	4	6	21	23	19
West Brom. A.	13	4	6	3	17	17	18
Port Vale	15	5	3	7	23	26	18
Newcastle United	14	4	5	5	14	15	17
Blackburn Rovers	15	5	2	8	20	23	17
Swindon Town	15	4	4	7	19	26	16
Bristol Rovers	13	4	2	7	17	20	14
Hull City	15	3	5	7	21	26	14
Leicester City	15	4	2	9	20	35	14
Oxford United	14	2	5	7	18	27	11
Charlton Athletic	15	2	4	9	16	24	10
Watford	14	2	3	9	11	21	9



HELPING THE GAME



The Football Trust 1990 has been created to help the game at all levels and to assist clubs meet the requirements of Lord Justice Taylor's Final Report.

Safety and comfort for all spectators is the primary objective and substantial funds have been made available for the provision of seating at Football League grounds. At the same time the Trust's commitment to family and community initiatives will continue with the provision of more family enclosures, better toilet facilities, covered accommodation, artificial pitches for local use and the development of women's and junior football particularly through community programmes, plus a wide range of policing and crowd control measures.

Each year The Trust expects to receive £20 million from the reduction in Pool Betting Duty plus the £10 million continuing contribution from the Spotting-the-Ball competition organised by Littlewoods, Vernons and Zettors. This money will be invested in projects which benefit football throughout the United Kingdom.

SWINDON TOWN

SHEFFIELD WEDNESDAY



FRASER DIGBY
16 appearances.



KEVIN PRESSMAN
17 appearances.



DAVID KERSLAKE
15 appearances.



JOHN HARKES
2 appearances.



PAUL BODIN
18 appearances, 2 goals.



PHIL KING
17 appearances.



ALAN McLOUGHLIN
12 + 3 appearances, 4 goals.



CARLTON PALMER
17 appearances, 1 goal.



ADRIAN VIVEASH
4 + appearances.



PETER SHIRTLIFF
17 appearances, 1 goal.



JON GITTENS
17 appearances.



NIGEL PEARSON
17 appearances, 3 goals.



TOM JONES
14 + 1 appearances.



DANNY WILSON
17 appearances, 3 goals.



DUNCAN SHEARER
15 appearances, 6 goals.



JOHN SHERIDAN
16 appearances, 6 goals.



STEVE WHITE
9 + 3 appearances, 3 goals.



DAVID HIRST
12 + 1 appearances, 11 goals.



ROSS MacLAREN
18 appearances.



PAUL WILLIAMS
17 appearances, 5 goals.



FITZROY SIMPSON
17 + 1 appearances, 3 goals.



NIGEL WORTHINGTON
17 appearances, 1 goal.



12. STEVE FOLEY
14. PAUL HUNT



12. TREVOR FRANCIS
14. LAWRIE MADDEN



Referee: N. Midgley



Linesman Red Trim: B. L. March
Linesman Yellow Trim: M. Sims

NEXT HOME MATCH: Swindon Town v Portsmouth
Saturday November 10th 1990. Kick-Off 3.00 p.m.

TODAY'S MATCH SPONSOR:

Sir Seton Wills & Family

TODAY'S BALL SPONSOR:

Edward and Trevor Howard of Fairford

Today's Mascot is RICHARD DLUCIK from Allied Dunbar. The position of Mascot has been donated as a 40th birthday present to Richard from his fellow supporters at Allied Dunbar.

You will have noticed that our Mascot tonight is a little older than usual. However, Richard's friends at Allied Dunbar are making a collection within the offices to honour his 40th birthday.

The proceeds will be donated to the Poppy Day Appeal.

Once again football fans are showing the kinder face of soccer.

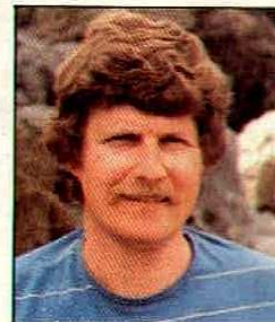

IMPORTANT SAFETY NOTICE

IMPORTANT SAFETY ANNOUNCEMENTS BY THE CLUB MANAGEMENT OVER THE PUBLIC ADDRESS SYSTEM WILL BE PRECEDED BY A LOUD SIGNAL TO CATCH THE ATTENTION OF SPECTATORS.